

ON LASER 2 sec = OFF

Lino L2G

Transportation

User Manual:

www.leica-geosystems.com

	LASER 2	
IEC 60825-1:2014	λ=510-530nm Pmax<1mW	tp=50-70µs

SAP. No. 864426B

- when it has to be right



Adapter setup

5/8"
1/4"

Usable with UAL 130

Usable with Receiver

Quick Start

Leica Lino L2G

- Status LED
- Laser key
- Battery pack
- Window of vertical line
- Window of horizontal line
- Levelling lock
- Tripod thread 1/4"

- when it has to be right



Insert batteries/Li-Ion



1x - Laser on

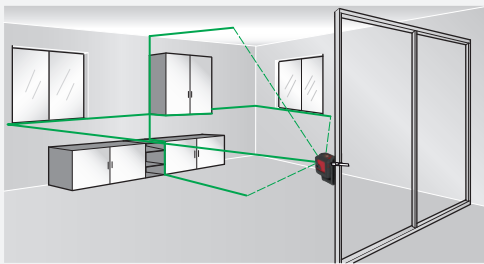

3x - Vertical mode

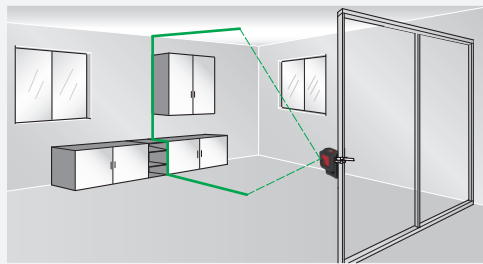

Charging Li-Ion battery

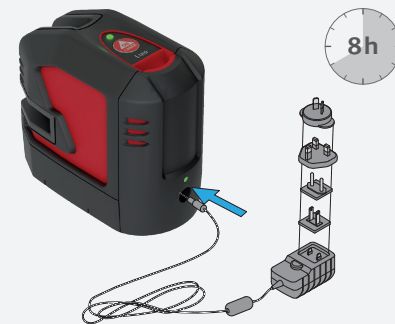

Self levelling / Levelling lock



2x - Horizontal mode

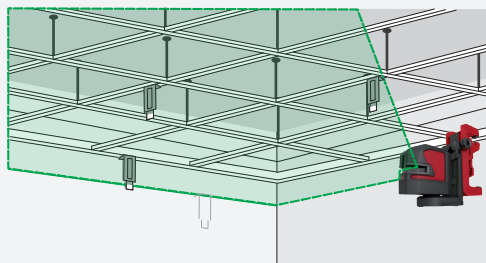

+ 1x — + 1x |

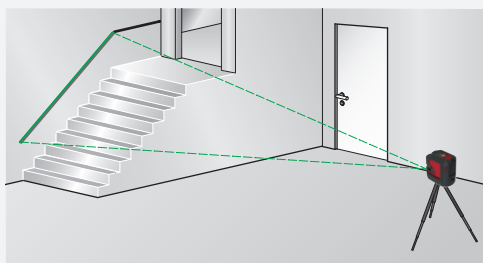

Status LED

